

Komaba Campus

0m 100m 200m 300m

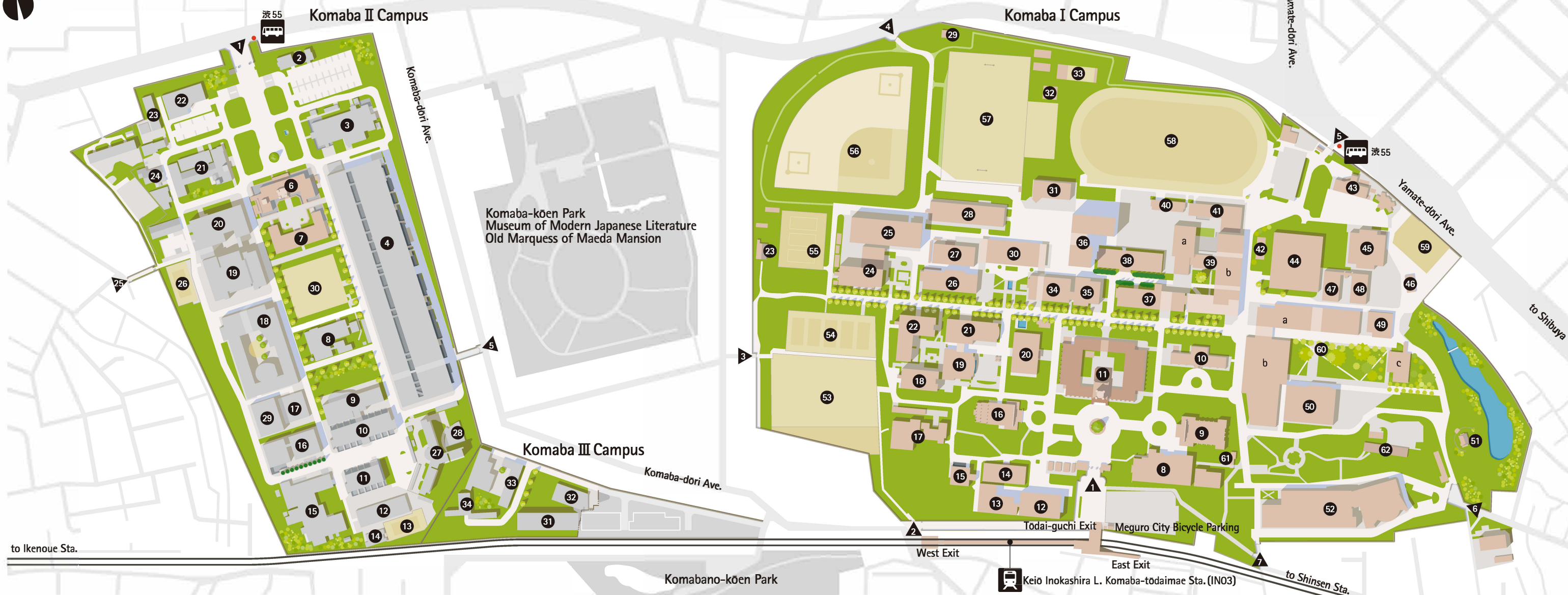

Komaba II & III Campus

- | | |
|--|-----------------------------------|
| ▲ 1 Main Gate | 21 IIS Central Workshop |
| 2 Garage | 22 Facility Center |
| 3 Bldg.1 (Wind Tunnel Lab.) | 23 Archaeological Excavation Unit |
| 4 Institute of Industrial Science (IIS) Research Bldg. (B-F Block) | 24 Co-op Refectory |
| ▲ 5 East Gate | ▲ 25 West Gate |
| 6 Research Center for Advanced Science and Technology (RCAST) Bldg.13 | 26 Tennis Courts |
| 7 RCAST Bldg.14 | 27 Komaba Lodge Annex |
| 8 Bldg.15 | 28 Multipurpose Hall |
| 9 IIS General Research Experiment Bldg. (An Block) IIS Convention Hall | 29 Komaba Open Laboratory Bldg. |
| 10 IIS General Research Experiment Bldg. (As Block) | 30 University Square |
| 11 IIS Research Bldg. (T Block) | 31 Komaba Lodge Main |
| 12 IIS Library | 32 Komaba Lodge A |
| 13 Tennis Courts | 33 Komaba Lodge B |
| 14 Bldg.59 | 34 Komaba Lodge C D |
| 15 IIS Research Bldg. (S Block) | |
| 16 Collaborative Research Bldg. (CCR) | |
| 17 Cafeteria / Conference Room | |
| 18 RCAST Bldg.4 | |
| 19 RCAST Bldg.3-South | |
| 20 RCAST Bldg.3 | |

Getting to the Komaba I Campus

- Shibuya Station (JR Yamanote Line, other lines)
<Train>Keiō Inokashira Line for Kichijōji
→ get off at Komaba-tōdaimae Station.
- Shimo-kitazawa Station (Odakyū Line) or Meidaimae Station (Keiō Line)
<Train>Keiō Inokashira Line for Shibuya
→ get off at Komaba-tōdaimae Station.

Getting to the Komaba II & III Campus

- See the homepage (<http://www.iis.u-tokyo.ac.jp>) for more details.
- Yoyogi-uehara Station (Odakyū Line, Subway Chiyoda Line) 12 minutes' walk.
 - Higashi-kitazawa Station (Odakyū Line) 8 minutes' walk.
 - Komaba-tōdaimae Station West Exit (Keiō Inokashira Line) 10 minutes' walk.
 - Ikenoue Station (Keiō Inokashira Line) 10 minutes' walk.

Komaba I Campus

- | | | | |
|--|---|--|--------------------------------|
| ▲ 1 Main Gate | 19 Bldg.12 | 38 Bldg.9 | 55 Tennis Courts |
| 2 Sakashita Gate | 20 Bldg.11 | 39 21 Komaba Center for Educational Excellence | 56 Baseball Field |
| ▲ 3 West Gate | 21 Bldg.13 | a. West Bldg. | 57 Rugby Field |
| 4 North Gate | 22 Bldg.14 | International Education Support Office Komaba Branch | 58 Athletic Field 1 |
| 5 Rear Gate | 23 Zanmai-do | Globalization Office | 59 Tennis Courts |
| ▲ 6 Suiji Gate | 24 Bldg.15 | b. East Bldg. | 60 Komaba Communications Plaza |
| ▲ 7 Bairin Gate | 25 Bldg.16 | 40 Extra-Curricular Activities Bldg. | a. KCP North Bldg. |
| 8 Administration Office | 26 Komaba International Building for Education and Research | 41 Student Bldg. | b. KCP South Bldg. |
| 9 Komaba Museum | 27 Bldg.17 | 42 Locker Rooms | c. KCP Japanese-style House |
| 10 Bldg.101 | 28 Bldg.3 | 43 University-wide joint use facility | 61 First-Year Activity Center |
| 11 Bldg.1 | 29 Greenhouse | 44 Gym 2 | 62 Math Sci Annex |
| Komaba Student Counselling Center | 30 Bldg.5 | 45 Gym 1 | |
| Academic Guidance Center | 31 Advanced Research Laboratory | 46 Day Care Center | |
| 12 Information Education Bldg. A | 32 Gym | 47 Campus Plaza Bldg. A | |
| 13 Information Education Bldg. B | 33 Kyudo Range | 48 Campus Plaza Bldg. B | |
| 14 Komaba Health Service Center | 34 Bldg.7 | 49 Multi-purpose Hall | |
| 15 Bldg.102 | 35 Bldg.10 | 50 Komaba Library | |
| Harassment Counseling Center (Komaba Room) | Center for Academic Writing at Komaba (CAWK) | 51 Hakuinsha Pavilion | |
| 16 Lecture Theater | 36 Bldg.18 | 52 Graduate School of Mathematical Sciences Bldg. | |
| 17 Komaba Faculty House | 37 Bldg.8 | 53 Athletic Field 2 | |
| 18 Bldg.2 | Disability Services Office | 54 Tennis Courts | |